



## Industrial Serial-Cellur Gateway

■ ■ SC5404D

- Support optional GSM/GPRS/EDGE/UMTS/HSDPA modems through RS-232 port
- xDSL(PPPoE) failover to 2G/3G modems
- 15KV ESD protection for serial signals
- Dual 10/100Mbps Fast Ethernet for redundancy with full duplex auto negotiation
- 4-port RS-232/422/485, baud rate up to 921 Kbps
- Rigid IP50 Metal housing, DIN-Rail and wall mount support
- Support RAW TCP Server/ TCP Client / UDP / Virtual COM / Tunneling Modes
- Configuration: Built-in Web Server /Serial Console/ Telnet / Windows-based Utility
- Monitor, manage and control industrial field devices remotely

### Make Serial Devices Ready to the Network

The Industrial Serial Server SC5404D is a cost effective gateway for Ethernet (TCP/IP) and serial signal communications; allowing almost any serial device to be connected to a new or existing Ethernet network.

By encapsulating serial data and transporting it over Ethernet, SC5404D offers full-duplex and bi-directional data seamlessly between the serial port and the Ethernet network.

### Easy to Use

Flexible configuration options enable this unit to be setup over Ethernet by Telnet, Web Browser, Serial Console, or our Windows Utility. Packed in a rugged metal housing for wall or DIN-Rail mount with 9~48VDC wide range power input, SC5404D is ideal for almost any industrial and manufacturing automation process.

Atop Virtual COM software provides a virtual environment for applications when accessing SC5404D through TCP.

### Specially Designed for Automation Fields

In industrial and manufacturing automation fields, SC5404D is used as a field device to connect the Ethernet through TCP/IP protocol directly. It is also specially designed for conjunction with PLCs, HMIs, Barcode Scanners, Data Terminals, Electronic Kanbans, Shop Floor Control Systems, and Pick-to-Light Systems.

Side View

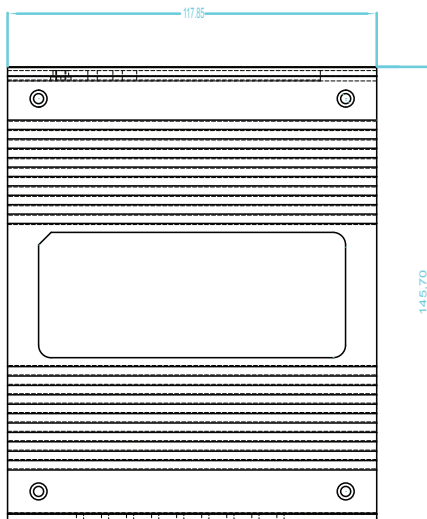

Rear View

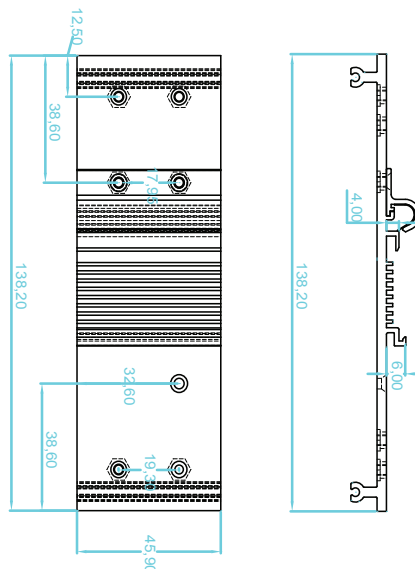

Top View

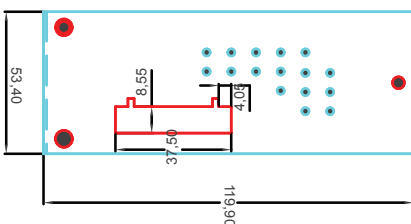

Dimensions (unit = mm)

Specifications	
<b>Network Interface</b>	
Ethernet	2x RJ-45 IEEE802.3u 10/100/100Mbps
<b>Serial Interface</b>	
Connector	D-Sub9 RS-232/422/485 software selectable
Ports	4 Ports (COM4 reserved for modem)
Baud Rate	300~921600Kbps
Parity	None, Odd, Even, Space, Mark
Data Bits	5,6,7,8
Stop Bits	1,2
Flow Control	None, Xon/Xoff, RTS/CTS
<b>Power Characteristics</b>	
Input Voltage	9VDC-48VDC
Input Current(9VDC)	0.65A
Power Consumption	Approx. 5.85W (max)
Power Redundancy	Yes
Reverse Polarity	Yes
Protection	
Connector	5.08mm 7-pin Lockable Terminal Block
<b>Mechanicals</b>	
Dimensions	53.4 mm x 145.7 mm x 119.9mm
Installation	DIN Rail, Wall Mount (optional)
Reset Button	Yes
Weight	900g
<b>Environmental Limits</b>	
Operating Temperature	-10°C ~ 60°C (14°F~140°F)
Storage Temperature	-40°C ~ 85°C (-40°F~185°F)
Ambient Relative Humidity	5~95% RH, (non-condensing)
<b>Software</b>	
Protocols	DDNS, DHCP Client, DNS, ERPS, HTTP, ICMP, IPv4, L2TP/IPSEC, NAT, NTP, PPPoE, PPTP, RFC2217, SMS, SMTP, SNMP, STP, Syslog, TCP, Telnet, UDP, VPN
Configuration	Serial Manager, Web UI, Serial console, Telnet
Virtual COM	Windows / Linux redirection software
<b>Link Modes</b>	
TCP Server	4 connections, Virtual COM, or Reverse Telnet
TCP Client	Dual destinations or Virtual COM
UDP	Up to 8 ranges of IPs
Warranty	5 years

## Regulatory Requirements

EMC				
EN 55022: 2007, EN 55024: 2003, FCC Part 15B, Class A				
Test		Item	Value	Level
IEC 61000-4-2	ESD	Contact Discharge	±4KV	3
		Air Discharge	±8KV	
IEC 61000-4-3	RS	Radiated (Enclosure)	10 V/m	3
IEC 61000-4-4	EFT	AC Power Port	±2.0 KV	3
		Signal Port	±1.0 KV	
IEC 61000-4-5	Surge	AC Power Port	Line-to- Earth ±0.5 KV	2
		Signal Port	Line-to-Earth±2.0 KV	3
IEC 61000-4-6	CS	Conducted (Enclosure)	10 V rms	1
IEC 61000-4-8	PFMF	(Enclosure)	1 A/m	
IEC 61000-4-11	DIP	AC Power Port	-	-

\*AC Ports are tested through an power adaptor available in the accessory.

Safety	EN 60950-1:2009
Shock	IEC 60068-2-27
Freefall	IEC 60068-2-32
Vibration	IEC 60068-2-6
MTBF	21.5 years
RoHS	Yes

## Ordering Information

SC5404D	P/N:1P1SC5404D0001G
	Industrial Serial-Cellular Gateway with optional modem

## Optional Accessories

US315-12 (US-Y)	P/N:50500151120009G
Power Adapter	Y-Type (5.08 mm) power adaptor, 100-240VAC input, 1.25A @ 12VDC output, US plug
USE315-12 (EU-Y)	P/N:50500151120019G
Power Adapter	Y-Type (5.08 mm) power adaptor, 100-240VAC input, 1.25A @ 12VDC output, EU plug
ADP-DB9(F)-TB5	P/N:59906231G
	Female DB9 to Female 3.81 TB5 Converter
WMK-459-Black	P/N:202EH731000003G
	Metal Wall Mount Kit, Black
CDK-459-Silver	P/N:201EH731000005G
	Conductive metal DIN-Rail Kit, Silver
2ESDPM-07P	P/N:50707871G
	7-pin 5.08mm Screw Terminal Block with 180° Angle
2ESDVM-07P	P/N:50707741G
	7-pin 5.08mm Screw Terminal Block with 90° Angle

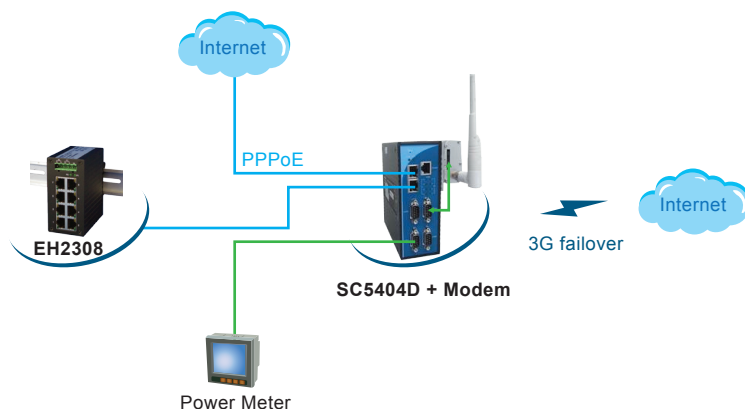

## Atop Technologies, Inc.

TEL : +886-3-5508137  
 FAX : +886-3-5508131  
 sales@atop.com.tw  
 http : //www.atop.com.tw

Design and specification are subjected to change without notice.  
 All product names referenced herein are registered trademarks of their respective companies.

